



## Installation Guide for Smoke Detector

Thank you for choosing Nyx Smoke Detector.

The product is a wireless smoke detector that ensures the safety of your home by identifying smoke arising from a fire. In case of a fire it notifies the gateway unit in its network and also rings a buzzer.

**The Box Contains-** Smoke Detector  
Battery  
Rawl plugs and Screws  
Installation guide

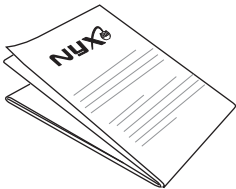
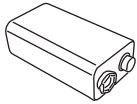
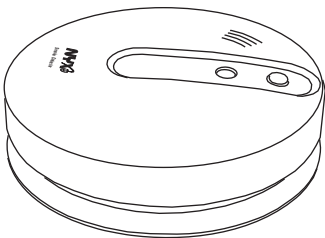

### Technical Specifications

Operating voltage	9V battery (6F22)
Static current	< 40uA
Battery life	1year
Detect indication	LED flashes, alarm sound (local at - sensor) >=85db., popup window along with buzzer on Gateway.
Radio frequency	866Mhz
Radio operating distance	50m line of sight
Operating temperature	-10deg C to +50deg C
Humidity	< 95%RH
Dimension	128mm diameter * 38mm
Detecting area	80msquare at 6-12m installation height 60msquare at installation height <6m.

### Pre installation check list

Avoid installations in places with stagnant smoke, heavy dust, water/oil mist, high humidity (>95%).

It should not be placed in a location, where there is direct air conditioner blow or high wind speed (>5m/s).

### Product setup and configuration

#### 1. Set the DIP switches as per instructions below:

**Note:**  
Make sure, DIP switches are set first and then batteries are inserted.

a) There are total 12 DIP switches. First 7 DIP switches should be set as per the settings shown on your NyxLite Gateway module.

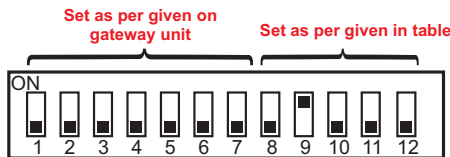
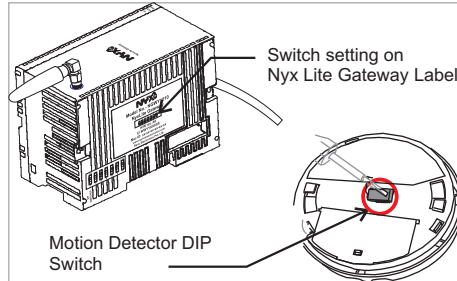

b) The remaining 5 DIP switches (Switch 8 to 12) are meant for room location of the device. Choose the location and set the DIP switch setting as shown in below table:

Smoke detector	1 0 1 1 0
----------------	-----------

#### How to set DIP switch to 1 or 0:

DIP Switch setting for position 0:	
DIP Switch setting for position 1:	

3. Insert the 9V battery cell as shown below:

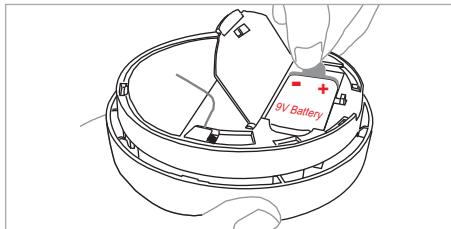

4. On top side of the detector, press the Test switch. A buzzer should beep, the LED should blink.

### Installation

1. Detach the mount plate from the bottom of the detector by rotating it anticlockwise.

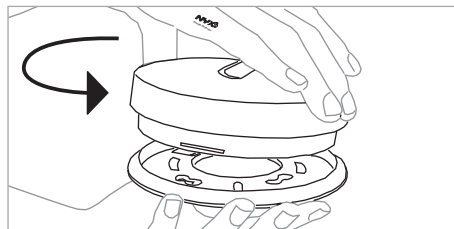

2. Screw the mounting plate on the ceiling where the detector needs to be installed using the rawl plugs and screws provided in the packaging.

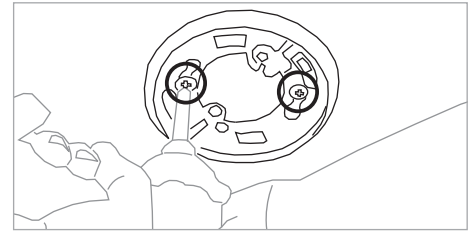

3. Install the detector by placing it on the mount plate to match the guide lines provided and then rotating it clockwise.

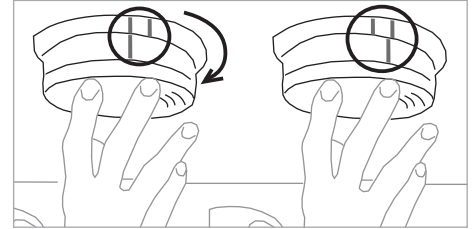

### Troubleshooting

- On pressing the Test switch on unit LED does not flash nor the local buzzer work.
  - Ensure that battery is inserted properly.
  - Use new battery.
- Smoke detector LED flashes, buzzer sounds but no indication on Gateway unit.
  - Ensure that the DIP switches are set as per instructions.
- Smoke detector does not operate.
  - Use a vacuum cleaner to blow compressed air to the openings around the perimeter for cleaning.